



e-ISSN: 2319-8753 | p-ISSN: 2320-6710

IJRSET

International Journal of Innovative Research in
SCIENCE | ENGINEERING | TECHNOLOGY

INTERNATIONAL JOURNAL OF INNOVATIVE RESEARCH

IN SCIENCE | ENGINEERING | TECHNOLOGY

Volume 9, Issue 9, September 2020

ISSN INTERNATIONAL
STANDARD
SERIAL
NUMBER
INDIA

Impact Factor: 7.512

9940 572 462

6381 907 438

ijirset@gmail.com

www.ijirset.com

Android Based Geo-Attendance System

Tamboli Shireen¹, Jadhav Ashwini¹, Mandlik Swapna¹, Shinde Kalyani¹, Tonape yogesh²

B.E. Student, Department of Computer Science Engineering, JSPM's Bhagwant Institute of Technology, Barshi, India¹

Professor, Department of Computer Science Engineering, JSPM's Bhagwant Institute of Technology, Barshi, India²

ABSTRACT-- In most educational institutions, participation of Teacher's in attendance process is regarded as a vital exercise for allowing knowledge transfer. One common method is by having Teacher's to manually sign the attendance sheet. Besides, such attendance sheet could easily be misplaced or lost. Besides that, the application will help to reduce time being wasted, leading to a higher learning productivity in class. There are a few paperless attendance systems such as Biometric, Android based that have been developed but such systems need to be equipped with either a computer or RFID reader, resulting in additional cost for hardware and its maintenance. With that in mind, we have aimed to address this issue by having a smart attendance system with minimal hardware and software requirement and at the same time, by using GPS and Geo-Fence technique and enhancing the mobility aspect of the existing attendance systems.

KEYWORDS: Manually signing, Smart Attendance, Biometric, RFID, GPS, Geo-Fence.

I. INTRODUCTION

Recording safe Teacher's or representative's attendance isn't a simple errand, in view of approval and constrained access to equipment gadgets one after another. In most instructive organizations, investment of Teacher's in participation process is viewed as a dynamic procedure for permitting information move. This shows the significance of having Teacher's to go to the booked talks and Task. Regular strategies for checking Teacher's participation are as yet embraced by most universities. One basic technique is by having Teacher's to physically sign the participation sheet



Fig. 1. Hardware based biometric attendance (existing) system

The target of this paper is to show how the usage of portable participation application created utilizing geo-fence strategy to exhibit the area of an individual utilizing a GPS advanced mobile phone. It is a framework that was intended to reduce contributions from clients. The proposed application was created on the android stage with GPS and Wifi4G advances. This is done to recognize the status of participation that is check in or check out. At long last, the director and staff can access and update the information in database.

III. REALTED WORK

Tracking with Global positioning System (GPS):

There are number of utilization that pre-owned GPS for following. GPS permits an article to be followed by identifying GPS unit that introduced in a gadget. At the point when an individual conveys that gadget, a satellite can recognize the GPS area. Presently a-days, a large portion of the advanced cells as of now installs a GPS unit. This segment will talk about related innovation for following frameworks dependent on GPS.



Following table shows the distribution of Location Based Queries (LBQ):

Table 1: Distribution of Location Based Queries

Location Based Queries(LBQ)			
Range Queries (RQ)	Nearest neighbor queries (NNQ):	Navigation queries (NQ)	Geofence queries (GFQ):
Range queries enable retrieve nearby location within a specified range of GPS location. Someone with GPS enabled device can search nearby objects using queries. The Application such as a store locator usually use this kind of queries.	For NNQ, the nearest object return to the specific location based on the queries.	With NQ, the user with a location can be instructed to follow the path to certain destination.	GFQ enables a user to create virtual boundaries of an area consist a number of coordinates. These coordinates represent a new specific area on the map. With these boundaries, many application can be implemented such as child tracking system or car tracking system.

What is “Geofencing”?

Geo-fencing is a virtual boundary that utilized the worldwide situating framework (GPS) or radio recurrence recognizable proof (RFID) to characterize geographical limits. Its capacity permits an application to trigger when a gadget crosses a Geofence and enters (or leaves) the limits characterized. Some application characterizes limits by longitude and scope or through client made and Web-based maps.



Fig.2. the Geofenced Area of BIT college, Barshi

Working:

To utilize geofencing, an overseer or designer should initially build up a virtual limit around a predefined area in GPS- or RFID-empowered programming. This can be as straightforward as a circle drawn 100 feet around an area on Google Maps, as indicated utilizing APIs when building up a versatile application. This virtual geofence will at that point trigger a reaction when an approved gadget enters or leaves that region, as indicated by the director or designer.



What is “Firebase”?

Firestore is a mobile-backend-as-a-service that provides powerful features for building mobile apps. Firestore has three core services:

- A real-time database
- User authentication
- Enabling offline support.

IV. PROPOSED SYSTEM SYSTEM SPECIFICATION

This archive subtleties the prerequisites of the executives framework for disseminated arrange. The product prerequisites will be determined for all the periods of the application. A product necessity particular is a finished depiction of the conduct of the framework to be created. It incorporate a lot of utilization cases are otherwise called utilitarian necessities. Notwithstanding use cases, it additionally contain non-utilitarian (Or Supplementary) prerequisites

Software Requirements

- Back End: Firebase (Database).
- RAM: Minimum 2GB Studio latest Version.
- Android SDK 7 and above.

Hardware Requirements

- Front End: Android
- Mobile phones with Android OS support.

SYSTEM DESIGN

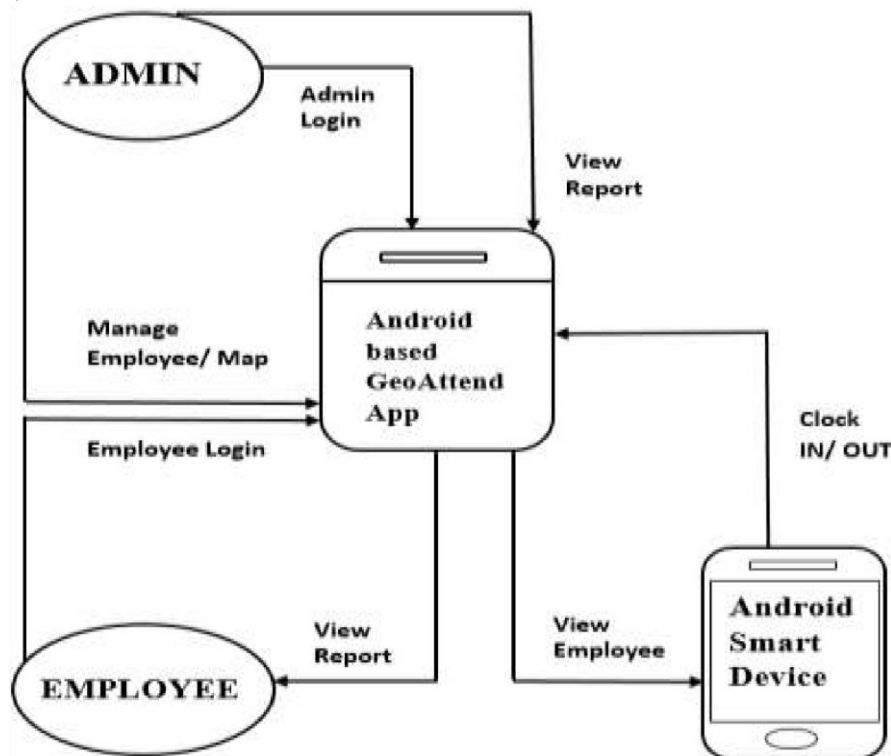

Fig.3.Block Diagram of System Design

WORKING OF “GEOATTEND” APPLICATION:

At whatever point a client or educator's go into the geofencing region of school gave by an application chairman, clients application "GeoAttend" gets initiated and naturally on the clock of the application and produces warning of entering in the geofencing region. In any case, one condition must be taken at the top of the priority list that GPS of Android telephone must be keep on. In the event that guess client don't have office of GPS on its cell phones client can go to their self by unique mark verification of cell phones. When the client entered in the geofencing territory, longitude and longitude area of client gets persistently sends after every 5 min. to administrator side for keeping track on client.



Result Evaluation and Analysis:

The framework gives simplicity of the executives to the overseers to view and track staffs' participation execution. This framework can make virtual limits of an organization area utilizing geo fence method with the goal that the framework can decide the staff is in substantial area or not.

Login/ Sign up page:

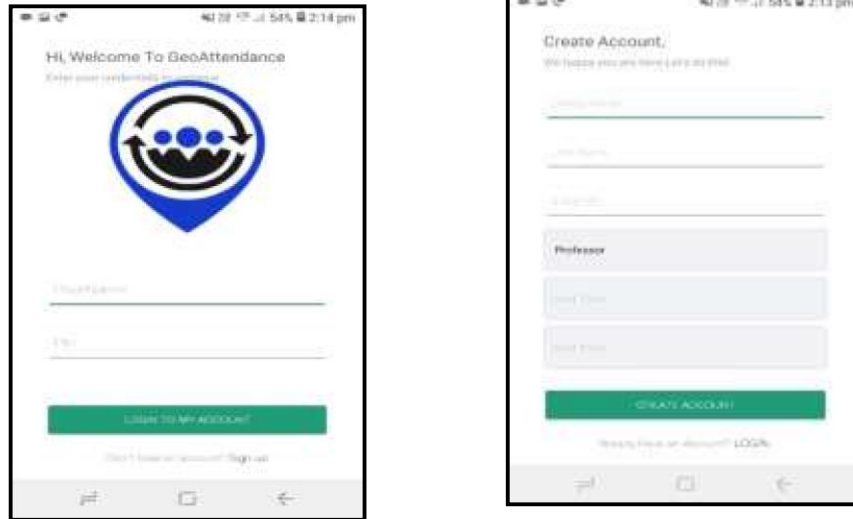

Fig.4. Login and Sign-up page for user and admin

Clock IN- Clock OUT Page:

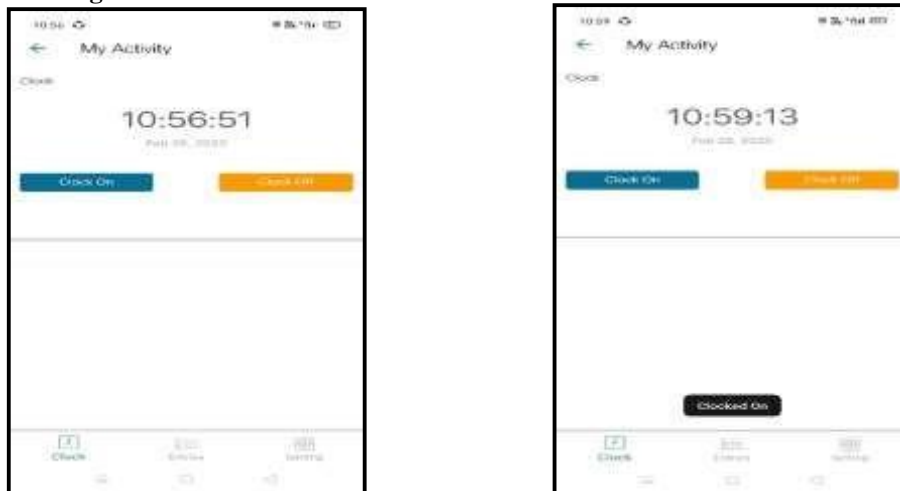

Fig.1.4.Clock-In Clock-Out Button on page



Fingerprint Authentication:

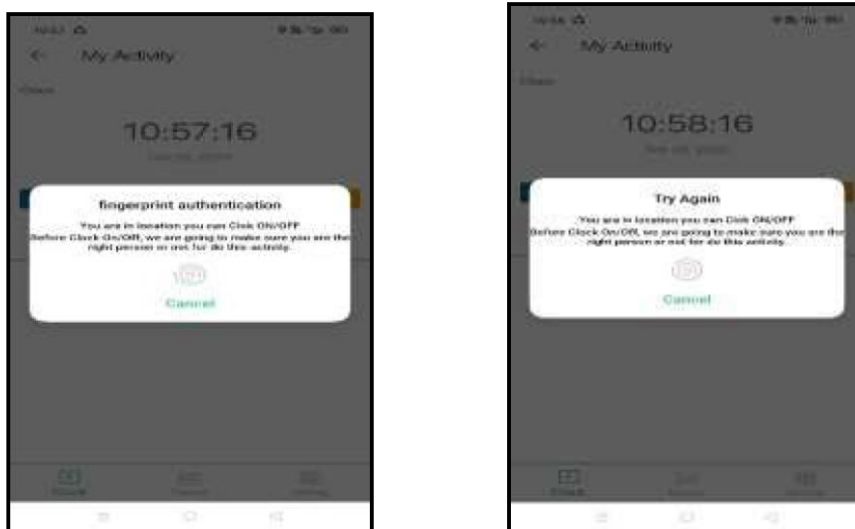

Fig.5. fingerprint authentication for clock-on and clock-out

Employee Monitoring Entries And Admin Side Entries:

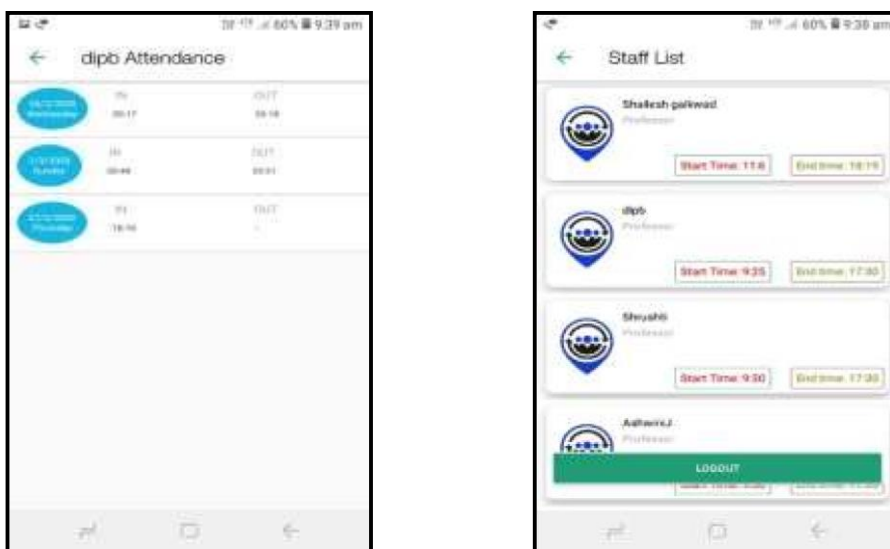

Fig.6. Entries on employee side and Admin side

V. CONCLUSION

The Android based Attendance System Using Geo-Fencing Application comprises of an Android advanced cell, GPS innovation, Wi-Fi passage and a server. The capacity of the whole framework is extremely straightforward. The future extent of the application is to create for different telephones too, for example, Symbian, Blackberry, and IOS.

REFERENCES

- 1] Yadav, M., Aggarwal, A., & Rakesh, N. (2018). Motion Based Attendance System in Real-Time Environment for Multimedia Application. 2018 8th International Conference on Cloud Computing, Data Science & Engineering (Confluence).doi:10.1109/confluence.2018.8442813
- 2] G Jaikrishna, Sugumar Rajendran, Cost-effective privacy preserving of intermediate data using group search optimisation algorithm, International Journal of Business Information Systems, Volume 35, Issue 2, September 2020, pp.132-151.



- 3] Noor, S. A. M., Zaini, N., Latip, M. F. A., & Hamzah, N. (2015). Android-based attendance management system. 2015 IEEE Conference on Systems, Process and Control (ICSPC). doi:10.1109/spc.2015.7473570.
- 4] Patel, Z., Senjaliya, N., & Tejani, A. (2019). AI-enhanced optimization of heat pump sizing and design for specific applications. International Journal of Mechanical Engineering and Technology (IJMET), 10(11), 447-460.
- 5] Al-Mazloun, A., E. Omer, and M. F. A. Abdullah. 2013. GPS and SMS-Based Child Tracking System Using Smart Phone. Australian Journal of Basic and Applied Science.
- 6] R.Sugumar, C.Jayakumar, A.Rengarajan, "An Efficient Blocking Algorithm for Privacy Preserving Data Mining", International Journal of Computing, USA, Vol. 3, Issue. 8, pp. 73-77, August 2011.
- 7] Isha Goel and Dilip Kumar. 2015. Design and Implementation of Android Based Wearable Smart Locator Band for People with Autism, Dementia, and Alzheimer. Advances in Electronics, vol. 2015, Article ID 140762.
- 8] M. F. Mahyidin. 2009. Student Attendance Using RFID System. University Malaysia Pahang.
- 9] **B.Murugeshwari**, R.Sujatha , Preservation of privacy for Multiparty Computation System with homomorphic encryption system , **International Journal of Emerging Technology and Advanced Engineering**, Vol No 04 Issue 03, 530-535 Pages, 2014 **ISSN : 2250-2459**
- 10] R. Gupta and BVR Reddy. 2011. GPS and GPRS Based Cost Effective Human Tracking System Using Mobile Phones. 7 (3).
- 11] Senjaliya, N., & Tejani, A. (2020). Artificial intelligence-powered autonomous energy management system for hybrid heat pump and solar thermal integration in residential buildings. International Journal of Advanced Research in Engineering and Technology (IJARET), 11(7), 1025-1037.
- 12] J.Sasidevi, R.Sugumar, Fuzzy C-means Clustering and Elliptic Curve Cryptography using privacy preserving in cloud, International Journal of Business Intelligence and Data Mining, Volume 15, Issue 3, pp.273-287, July 2019.
- 13] Shibata, H., "An attendance management system using mobile phones", Communications, Computers and signal Processing, 2005. PACRIM. 2005 IEEE Pacific Rim Conference on, vol., no., pp.590, 592, 24-26 Aug. 2005.



INNO SPACE
SJIF Scientific Journal Impact Factor

**Impact Factor:
7.512**

ISSN INTERNATIONAL
STANDARD
SERIAL
NUMBER
INDIA



INTERNATIONAL JOURNAL OF INNOVATIVE RESEARCH

IN SCIENCE | ENGINEERING | TECHNOLOGY

 9940 572 462  6381 907 438  ijirset@gmail.com



www.ijirset.com

Scan to save the contact details