



e-ISSN: 2319-8753 | p-ISSN: 2320-6710

# IJIRSET

International Journal of Innovative Research in  
**SCIENCE | ENGINEERING | TECHNOLOGY**



# INTERNATIONAL JOURNAL OF INNOVATIVE RESEARCH

IN SCIENCE | ENGINEERING | TECHNOLOGY

Volume 10, Issue 1, January 2021

**ISSN** INTERNATIONAL  
STANDARD  
SERIAL  
NUMBER  
INDIA

**Impact Factor: 7.512**

 9940 572 462

 6381 907 438

 [ijirset@gmail.com](mailto:ijirset@gmail.com)

 [www.ijirset.com](http://www.ijirset.com)



# Analysis of Multistoreyed Building on Sloping Ground Considering Wind Effect and Soft Stories

Md.Yahya Junaidi<sup>1</sup>, Mohammedmansoor Ahmed<sup>2</sup>

P.G. Student, Department of Civil Engineering, KBN College of Engineering Kalaburagi, Karnataka, India<sup>1</sup>

Professor, Department of Civil Engineering, KBN College of Engineering Kalaburagi, Karnataka, India<sup>2</sup>

**ABSTRACT:** The main aim of the structure engineer is to design the structures for a safe, serviceable, durable and economical one, with development of technology in the computing field; the structural engineer can dare to tackle much larger and complex structures subjected to various types of loading conditions. Earlier the loads acting on the structures are considered as static or pseudo static, but strictly speaking, with the exception of the self-made (dead load) no structure load is static one. With the development of computing facility, the structural engineer attempted to consider the other loads which are varying with time called as dynamic loads. Nowadays a large number of applications software's are available in the civil engineering field. All this software's are developed as the basis of advance finite element analysis which includes the effect of dynamic loads such as wind effects, earthquake effects etc. In the present work, an attempt has been made to study efficiency of certain civil, engineering application software's by using software E-TAB. Four model are prepared to study the displacement, story drift, time period and base shear.

**KEYWORDS:** MultistoreyedBuilding, Sloping Ground, Wind Effect, Soft stories, E-TAB'S

## I. INTRODUCTION

**1.1 GENERAL :** In each part of human development, we required structures to live in or to get what we need. However, it isn't just structure. However, to assemble productive buildings such that it should satisfy the primary reason for which it was meant for, in this part of structural designing, all the accurately the function of investigation of buildings. Many traditional strategies are there to tackle plan issue and with time new programming likewise becoming possibly the most important factor. In the present venture work later from programming known as ETABS has utilized.

The main role of a wide range of auxiliary frameworks utilized in structure kind of building to help gravity loads. Widely recognized burdens coming about because of the impact of gravity are dead burden, live burden and snow load. Alongside this gravity burdens structure are likewise exposed to parallel burdens brought about by wind, seismic tremor. Horizontal burdens can grow high anxieties produces influence second or cause vibration. Along these lines, it is significant for the structure to have adequate quality against vertical loads along with sufficient solidness to oppose parallel powers. Strengthened solid structure can be grouped are:

1. Structural edge framework: The auxiliary framework comprises of edges, floor chunks, pillars and section are the premise components of basic framework.
2. Structural divider framework: In this sort of structures, all material individuals are made of basic dividers, for the most part called shear dividers.

## 1.2 OBJECTIVES OF THE STUDY:

Present work is to investigate the analysis of multistoried building subjected to gravity loads (dead and live) and laterally loads (wind).

- I. To determine the slope Which is subjected to less displacement.



- II. To study the variation of displacement and drift at each storey considering different slopes of ground.
- III. To study the variation of base shear and Time period at different ground slopes.

### 1.3 TERMINOLOGY

#### Base:

It is the position at which inactivity powers created in the building are moved to the establishment, which at that point moves these powers to the ground.

#### Storey:

This is the gap between two nearby floors.

#### Soft Storey:

A delicate story is a story wherein at least one stories un hindered or different openings. It is one in which the parallel solidness is under 70% of that in the story above or under 80% of the normal horizontal firmness of the three stories above.

#### Storey Drift:

The displacement of a floor comparative with the floor above or underneath.

#### Base Shear:

It is an assessment of most extreme sidelong power that will happen because of seismic ground movement at the base of building.

## II. RELATED WORK

[1]**Dr. R. B. Khadiranaikar and ArifMasali:**They carried out study on “Seismic behaviour of buildings constructed on slope Ground–A review”. This investigation provides the information in the seismic reaction of Structures on slope slants. The reaction of the building on slope incline has been talked about. A survey on the seismic conduct of structures laying on slanting ground has introduced. It is Seen that the seismic conduct of structures on inclining ground contrast from different Structures.

[2]**Mr.Achin Jain, Dr.RakeshPatel:**This paper entitled “Analysis of building constructed on sloping ground for different types of soil” explains the seismic conduct of high rise structures on slanting ground accounting soilstructure communication. The investigation of G.F+4 storey R.C.C expanding on changing slant points i.e., 0,100,150,200,250 and 300 is examined and contrasted and the equivalent on level surface. It has seen that the balance segments of more limited stature pull in more powers, in light of an impressive increment in their firmness, which thusly expandsthe even power (for example shear) and twisting second fundamentally.

[3]**Vipin V. Halde, Aditi H. Deshmukh:** This paper describes the “Study on performance of soft storey in structure”. From the Above it is seen that, when the impact of delicate storey is viewed as then the diversion hasIncrement at that specific floor. RC diagram building with open first story are known to Behave ineffectually during in strong shudder shaking.

[4]**Joshua Daniela, and Sivakamasundarib:**They carried out project on “Seismic behaviour of stiffness irregular building on hill Slope”. Because of shortage of flat ground, structures are built in the slope territory with Sporadic basic configuration having establishment at different level. In this investigation theSeismic load of ordinary structure on flat ground is compared to that of the slope building. An Explanatory examination was performed to explore the conduct of expanding on slope slant.



[5]Sandeep goyal:This paper entitled “Dynamic analysis of sloped buildings: Experimental and Numerical studies” shows that 15 degree inclined casing encounters greatest storey dislodging In light of low worth of solidness of short segment while the 25 degree layout experiences Least story dislodging.

### III.STRUCTURE DATA

#### 3.1BUILDING DESCRIPTION

Here we work on the residential structure of G+25 floors.

Total height :-

- Model 1 = 83.1m
- Model 2 = 84.85m
- Model 3 = 86.60m
- Model 4 = 88.45m

The G.F is constructed for parking having its height 2.5m.

No flat is made for 13thstorey with its height of 2.5m.

All other stories of 3.2m height.

Four seperate models were studied:

- Model 1: G+25 with soft stories at 0° ground slope.
- Model 2: G+25 with soft stories at 5° ground slope.
- Model 3: G+25 with soft stories at 10° ground slope.
- Model 4: G+25 with soft stories at 15° ground slope.

The algorithm automatically generates mask image without user interaction that contains only text regions to be inpainted.

#### 3.2 DESIGN LOADS

The heap thought to be created by the planned use or inhabitation of a structure. Counting the heaviness of portable parcel appropriated, concentrated burdens, load because of effect and vibration, and residue load yet barring wind, seismic, dayoff different loads due to temperature changes, creep, shrinkage, differential settlement, and so on.

Live load = 3KN/m

Super imposed load = 1KN/m

Load of wall for 3.2m high

Density of wall = 18 KN/m<sup>3</sup>

$3.2 \times 0.23 \times 18 = 11.385 \text{KN/m}$  (230 mm wall)

For parapet wall for 1m height

$1 \times 0.1 \times 18 = 1.8 \text{KN/m}$

Beam size = 300x450mm

Column size = 750x900mm

Concrete Grade = M40

Steel Grade = Fe415

#### 3.3 DESIGN WIND SPEED (V):

The fundamental wind speed at any location can be taken by considering the following factors.

- a. Probability level
- b. Topography roughness, height, dimension of building
- c. Geography

It very well may be numerically discussed below:

Here,

$$V_s = V_b \times K_1 \times K_2 \times K_3$$

$V_s$  = design breeze speed

$K_1$  = Risk co-efficient

$K_2$  = topography, tallness and building dimension factor

$K_3$  = Terrain factor

### 3.4 WIND EXPOSURE PARAMETER :

$$\text{Angle of wind in x-axis} = 0^\circ$$

$$\text{Angle of wind in y-axis} = 90^\circ$$

$$\text{Up wind co-efficient} = 0.8$$

$$\text{Down wind co-efficient} = 0.5$$

#### Wind coefficient :

$$\text{Breeze speed, } V_b = 44 \text{ m/s}$$

$$\text{Topography category} = 4$$

$$\text{Building type} = C$$

$$\text{Probability co-efficient, } K_1 = 1$$

$$\text{Terrain, } K_3 = 1$$

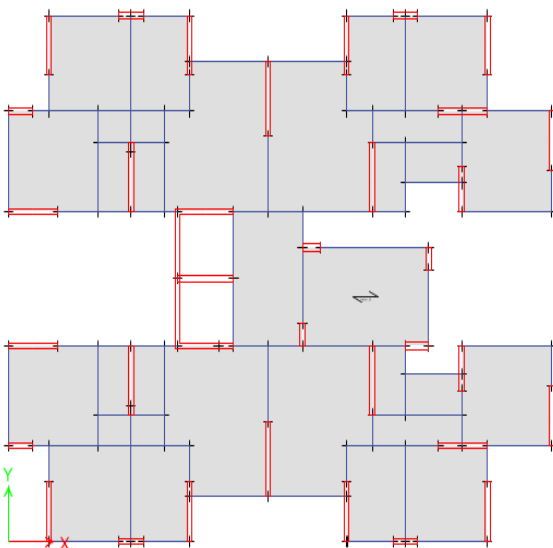

Fig. 1 : PLAN

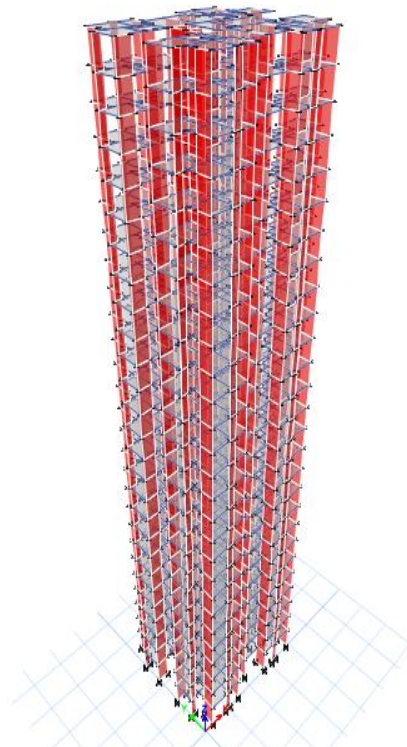

Fig. 2 : 3D MODEL



#### IV. MODELLING USING ETABS

##### 4.1 DETAILS OF SOFTWARE ETABS

###### The ETABS System:

ETABS examines and plans your structure utilizing a model that you make utilizing the graphical UI. The way to effectively actualizing ETABS is to comprehend the exceptional and ground-breaking approach the program takes in displaying building frameworks.

###### General features of software etabs

1. Optimized for modelling of multistorey building
2. CAD drawing / altering for quick, instinctive outlining format
3. 3D model age utilizing plan and hoist
4. Fast age of model utilizing the idea of comparative stories
5. Automated templates for typical structures
6. Easy altering with move, union, reflect and imitate
7. Convenient separating and cross section of configuration objects
8. Accurate dimensioning with guidelines and snapping
9. Quick-attract alternatives to make objects with one mouse click
10. Multiple perspectives in 3D viewpoint with zoom and pan
11. On screen assignment of properties, loading and supports
12. Powerful grouping, selection and display options
13. Cut copy and paste options.

##### 4.2 BASIC PROCESS

The accompanying gives a wide outline of the fundamental demonstrating, examination, and configuration measures:

1. Units have to set.
2. File have to open.
3. Grid lines set up.
4. Mention floor level.
5. Properties of member.
6. Draw objects.
7. Assign properties.
8. Give load case.
9. Give loads.



10. Modify the geometry.
11. View model.
12. Examine building.
13. View results for assessment.
14. Structure to design.
15. Output.

V. RESULTS

5.1 DISPLACEMENT

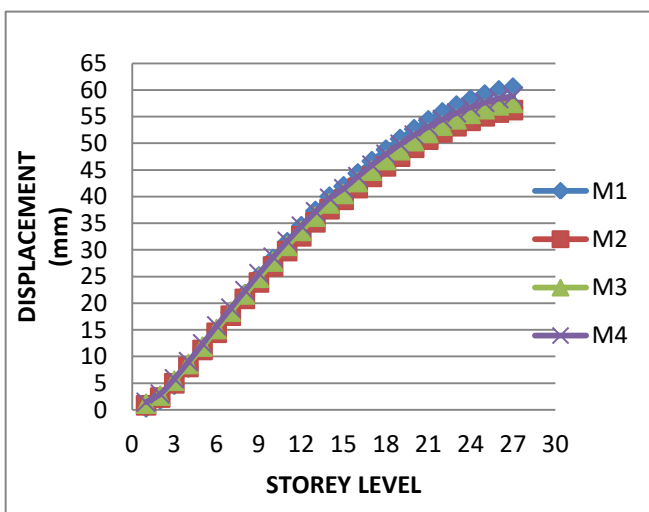

Chart 1: Displacement along X direction

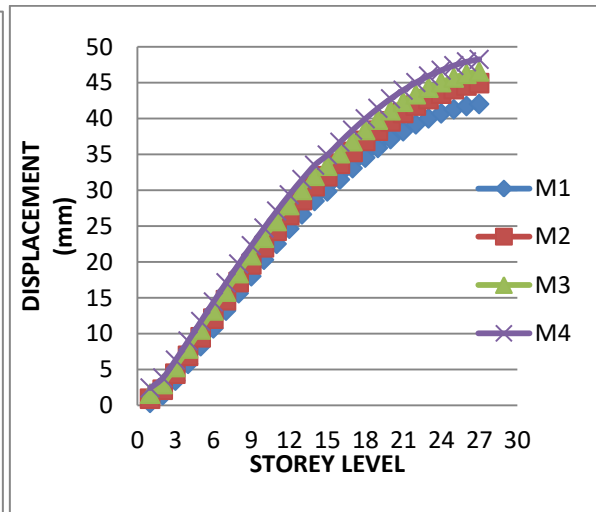

Chart 2: Displacement along Y direction

5.2 STOREY DRIFT

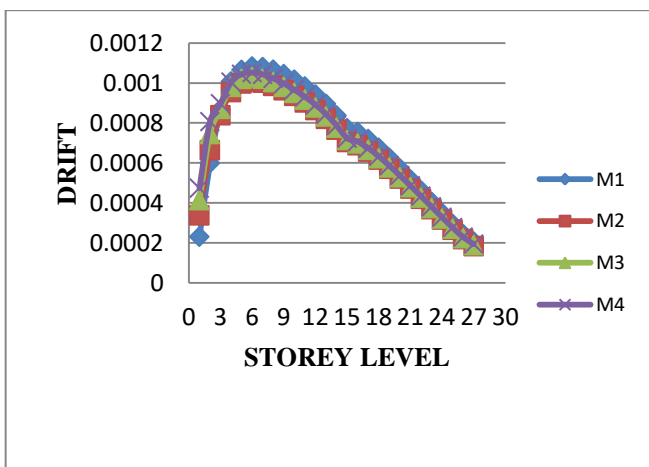

Chart 3: Drift along X direction

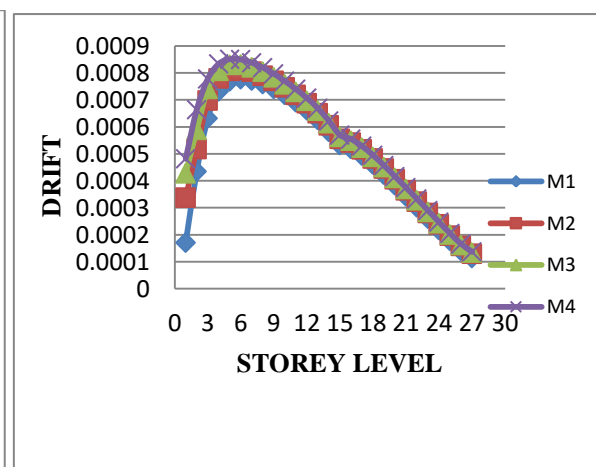

Chart 4: Drift along Y direction



5.3 BASE SHEAR

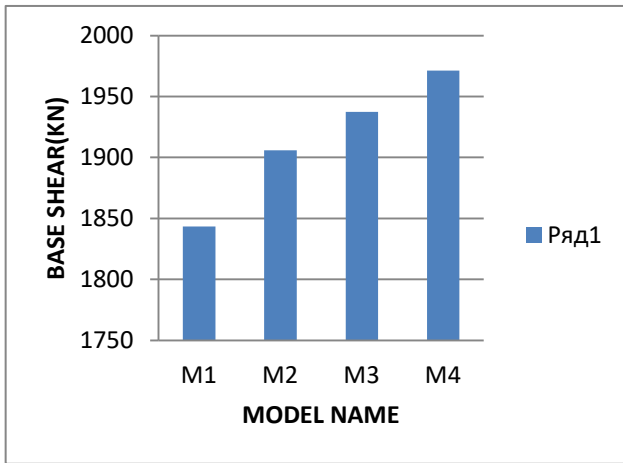

Chart 5: Base shear in X direction

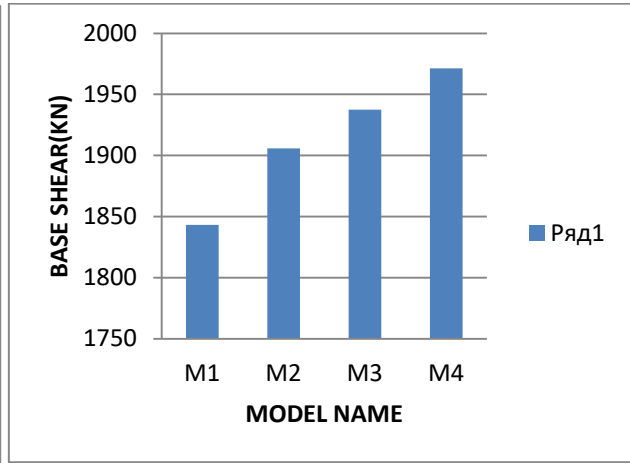

Chart 6: Base shear in Y direction

VI. CONCLUSION

1. The application software used in the present work such as ETABS is most user friendly.
2. ETABS will give clear information about errors which occurs while creating structure in input file
3. In model 1 and 2, the drift along X-axis is gradually increases and afterwards decreases.
4. Compared to remaining models, the drift in model 3 is less.
5. The displacement, drift and time period is decrease for Model 2.

REFERENCES

- [1] Dr. R. B. Khadiranaikar and ArifMasali “Seismic behaviour of buildings constructed on slope ground–A review”. IOSR Journal of Mechanical and Civil Engineering. Volume 11, Issue 3, Ver III, May-June 2014. PP 12-19.
- [2] Mr.Achin Jain, Dr.Rakesh Patel “Analysis of building constructed on sloping ground For different types of soil”. International Journal for technological research in Engg. Volume 4, Issue 12, August-2017.
- [3] Vipin V. Halde, Aditi H. Deshmukh “Study on performance of soft storey in structure”. International Research Journal of Engg and Technology. Volume 02, Issue 08, Nov-2015.
- [4] Joshua Daniela,\* and Sivakamasundarib “Seismic behaviour of stiffness irregular Building on hill slope”.Journal of Aerospace and Lightweight Structures. Volume 4, No 4, 2014, Pages-281-300.
- [5] Sandeep goyal “Dynamic analysis of sloped buildings: Experimental and numerical Studies”. National Institute of Technology ODISHA, INDIA. 222





**INNO**  **SPACE**  
SJIF Scientific Journal Impact Factor

**Impact Factor:  
7.512**

**ISSN** INTERNATIONAL  
STANDARD  
SERIAL  
NUMBER  
**INDIA**



# INTERNATIONAL JOURNAL OF INNOVATIVE RESEARCH

IN SCIENCE | ENGINEERING | TECHNOLOGY

 **9940 572 462**  **6381 907 438**  **ijirset@gmail.com**



[www.ijirset.com](http://www.ijirset.com)

Scan to save the contact details