



e-ISSN: 2319-8753 | p-ISSN: 2347-6710

IJRSET

International Journal of Innovative Research in
SCIENCE | ENGINEERING | TECHNOLOGY

INTERNATIONAL JOURNAL OF INNOVATIVE RESEARCH

IN SCIENCE | ENGINEERING | TECHNOLOGY

Volume 12, Issue 11, November 2023

ISSN INTERNATIONAL
STANDARD
SERIAL
NUMBER
INDIA

Impact Factor: 8.423

9940 572 462

6381 907 438

ijirset@gmail.com

www.ijirset.com

Seismic Performance of high-rise Buildings with Different Structural Systems

Vedant Chalse¹, Vishwajeet Kadlak²

P.G. Student, Department of Civil Engineering, Dr. D Y Patil School of Engineering and Technology, Charholi (BK), Pune, Maharashtra, India¹

Associate Professor & PG Coordinator, Department of Civil Engineering, Dr. D Y Patil School of Engineering and Technology, Charholi (BK), Pune, Maharashtra, India²

ABSTRACT: In the present world scenario, construction of high rise building is being preferred due to rapid increase in the cost of land, lack of land availability and also to preserve land in rural areas for agricultural use. The design of high rise buildings is primarily governed by wind and seismic loads. The performance of the buildings depends on the structural configuration and the present study aims at comparing the performance of high rise building with different configurations.

In the present study, high rise buildings have been investigated under the effect of seismic loads with different structural, namely, (i) special moment resisting frames (ii) frame-shear wall buildings (iii) outrigger systems (iv) braced model . The building models are assumed to be located in Guwahati, Assam which is one of the most earthquake-prone zones in India

A detailed analysis of the building system is done by modeling the geometry, material section properties and boundary conditions. All the analysis and design work is conducted using ETABS 2016 version. The post analysis consist typical characteristic comparison related to storey displacement, storey drift, Story Shears. Etc

KEYWORDS: High rise building; finite element; frame-shear wall system, out-trigger systems.

I. INTRODUCTION

Over the past years, the procedure for designing high rise buildings has changed. Building high rise buildings is preferred in the current scenario due to a rapid rise in land costs and unavailability of land. The lateral loads govern the design of high rise Buildings as these loads tend to cause dynamic actions on high rise buildings. Depending on the site parameters and height, the effect of these loads is predominant on high rise buildings. It should be ensured that, even when exposed to lateral loads, the structure must be nonviolent and functional during its anticipated life.

Analysis of high rise buildings is of paramount importance to the engineers. To design a structure, these loads must be resisted by specifying the forces on the structure. The high rise buildings subjected to lateral loads involve excessive degrees of freedom, making it difficult to determine the responses involved in computational work (stress, displacement, drift, etc.). A more detailed analysis is generally sidestepped by making some valid assumptions to make the solution practically feasible. Therefore, there is a definite need to satisfy the trade-off between results accuracy and the cost of calculation to analyze large buildings.

Because of their aesthetic beauty, high rise towers and buildings have captivated humankind since the commencement of civilization. The building practice of high rise buildings was instigated in the 1880s and has grown for commercial and inhabited purposes in large part. The fast-growing commercial activities to be as close to each other and the city center, are primarily responsible for creating high rise commercial buildings, stroking powerful weight on the existing land. The high land costs and the requirement to preserve noteworthy agricultural production contributed to driving inhabited buildings upward.

The viability of high rise buildings is always dependent on the resources available, the level of edifice expertise, and the state of progress of the amenities needed for building use. As an outcome, significant progress has occurred in the history of high rise buildings from time to time. At the same time, the designers must bear in mind the building's security and serviceability criteria. In developing an appropriate lateral force resistance system, it is necessary to plan rigid plane interconnections between the different perpendicular apparatuses to form complex assemblages such as coupling walls and rigid frames that generate a whole structural assembly with lateral rigidity many times greater than the sum of the lateral rigidity of the discrete perpendicular components.

DIFFERENT FORMS OF HIGH RISE BUILDINGS

In the field of high rise buildings, there are several structural forms that have evolved to date. For all these structural forms, the fundamental design philosophy is to put maximum possible load bearing element around the exterior peripheral of buildings to maximize their flexural stiffness. It is possible to take advantage of all structural forms by placing the foremost vertical members and overturning the lateral load tensile pressures with the compressive pressures from self-weight. The different high rise building structural forms which are presented in this study are namely: (i) special moment resisting frames, (ii) frame-shear wall buildings, (iii) outrigger systems, (iv) braced model.

II. METHODOLOGY

Draw the various structure of different structure system in e-tab software, assigning the all section and material properties. Analyse the all structures and comparison carried out. The all structures is compare with story displacement, story shear and story drift.

EVALUATION

Four different structural systems, namely, rigid frame system, shear wall system, braced system, outrigger system of the same plan dimension of 36 m by 36 m are analyzed using 'ETABS 2016' with finite element modeling technique. The models are G+20 storeyed concrete frames with steel bracings and outriggers with a height of 63 m. The buildings are assumed to be located in seismic zone factor V.

The building nomenclatures for the four different building models are shown in table 1. The buildings name starting with 'p' indicates plan, following with a number which indicates the plan number and the last alphabet indicates the building type (R- rigid frame, S- shear wall, B- braced system, O- outrigger system).



Table 1 Building Nomenclature

BUILDING TYPE	NAME
Rigid frame system	P-I-R
Shear wall system	P-II-S
Braced frame system	P-III-B
Outrigger system	P-IV-O

Materials and Geometry

The buildings have concrete frames of rectangular beams and columns, with concrete walls 250 mm thick and 175 mm thick slab. The shear walls are 250 mm, 200 mm and 150 mm thick for Shear wall model, outrigger model respectively. Steel bracings used as outriggers and bracings are ISWB sections. The materials used are M30 concrete and FE550 grade steel.

The various plans and elevation of the models investigated in this study are shown in Figure.

Parameter	Description
Plan Area	1296 sqm
Number of Storey	20
Total Height of Structure	63m
Height of each storey	3
Grade of Concrete	M30
Grade of Steel	Fe500
Seismic Zone	V
Importance Factor	1.2
Response Reduction factor	5
Damping ratio	5%

Member sizes for P-I-R

Story No.	Column size (mm x mm)	Beam size (mm x mm)
1-2	1200 x 1200	800 x 400
3-5	1100 x 1100	800 x 400
6-10	1050 x 1050	800 x 400
11-15	1000 x 1000	800 x 400
16-20	950 x 950	800 x 400

Member sizes for P-II-S

Story No.	Column size (mm x mm)	Beam size (mm x mm)	Shear wall thickness (mm)
1-5	1100 x 1100	800 x 400	250
6-10	1000 x 1000	800 x 400	250
11-15	900 x 900	800 x 400	250
16-20	800 x 800	800 x 400	250

1) DESIGN LOADS:

Self Weights

Self-weight of the structural members will be calculated on the basis of the following properties.

- Density of reinforced concrete - 25.0 kN/cu.m
- Density of plain concrete - 24.0 kN/cu.m
- Density of steel - 78.5 kN/ cu.m
- Density of floor finishes / plasters - 20.0 kN/ cu.m

1) Loading due to wall –

Thickness on wall – 150mm

Dead load of walls on beam – $(3-0.4)*0.15*20 = 7.8 \text{ Kn/m}$

Thickness on wall – 100mm

Dead load of walls on beam – $(3-0.4)*0.10*20 = 5.2 \text{ Kn/m}$

2) Live Loads and floor finishes loads

Live load for Residential Floors - 2.0 kN/sq.m
Floor Finish - 1.5 kN/sq.m

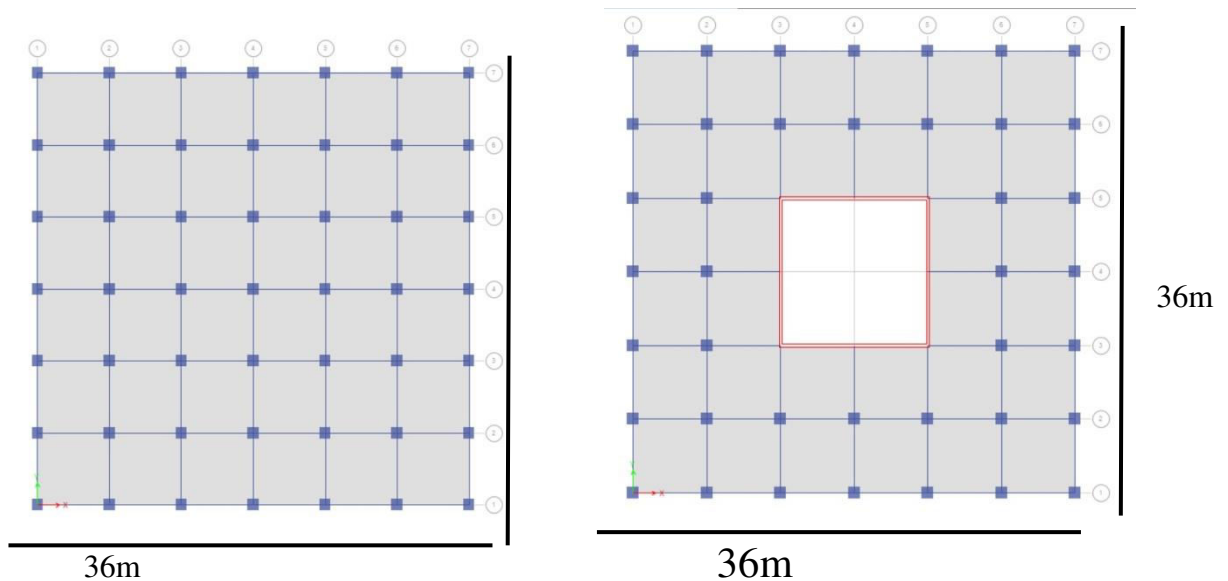

2-D plan for rigid frame system and shear wall system

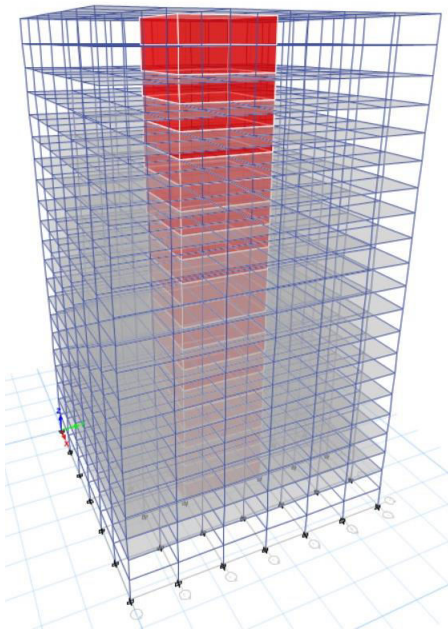

Model from ETABS of shear wall system

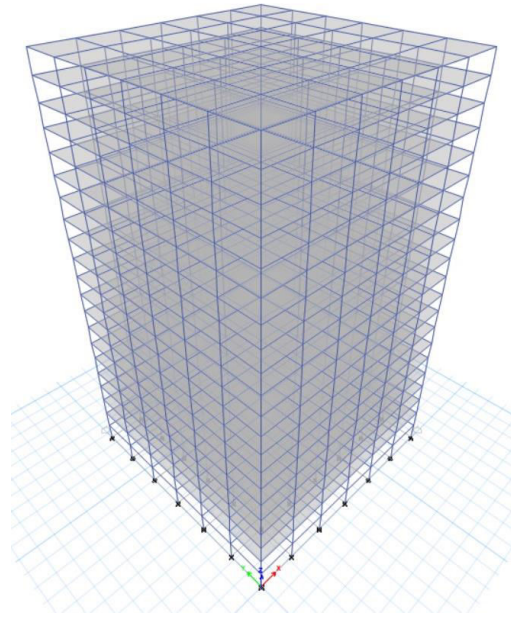

Model from ETABS of Rigid Frame system

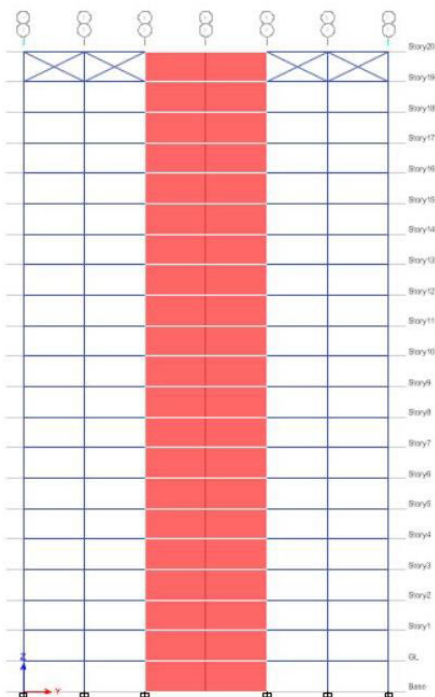

Model from ETABS of outrigger system

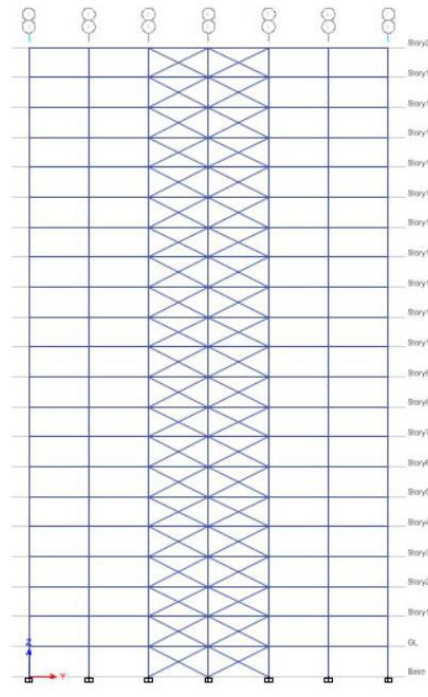

Model from ETABS of Brace Frame system

Design

A detailed procedure of analysis is performed for four different structural systems of high-rise building. The analysis results (building responses) for different systems are compared to get the performance of various stiffening systems used in the study.

Four 20 strayed building models of different structural systems of high-rise building, namely,

rigid frame model, shear wall model, braced frame model, outrigger model are modeled using finite element modeling technique in 'ETABS 2016'. A linear response spectrum analysis is conducted with seismic loading according to IS 1893 (2002).

The members are designed with 3-4% rebar percentage and keeping column/beam capacity ratio equal or more than 1.5. It is checked whether the members are passing the design or not, to fix the member sizes. Further with a target displacement of 0.126 m, the member sizes are optimized. This displacement is taken as $H/500 = 0.126$ m, the acceptable limit for maximum displacement as per IS 1893 (Part 1): 2002. The various parameters, such as base shear, inter-story drift ratio, roof displacement, etc. are compared for the different structural systems. Meanwhile, the results are compared with the loads calculated manually and it is checked whether the results are within acceptable limit or not. The member sizes optimized for different models.

Table 2 (a) Member sizes for P-I-R

Story No.	Column size (mm x mm)	Beam size (mm x mm)
1-2	1200 x 1200	800 x 400
3-5	1100 x 1100	800 x 400
6-10	1050 x 1050	800 x 400
11-15	1000 x 1000	800 x 400
16-20	950 x 950	800 x 400

Table 2 (b) Member sizes for P-II-S

Story No.	Column size (mm x mm)	Beam size (mm x mm)	Shear wall thickness (mm)
1-5	1100 x 1100	800 x 400	250
6-10	1000 x 1000	800 x 400	250
11-15	900 x 900	800 x 400	250
16-20	800 x 800	800 x 400	250

Table 2 (c) Member sizes for P-III-B

Story No.	Column size (mm x mm)	Beam size (mm x mm)	Bracing member
1-2	1200 x 1200	800 x 400	ISWB 550
3-7	1000 x 1000	800 x 400	ISWB 550
8-20	900 x 900	800 x 400	ISWB 550

Table 2 (d) Member sizes for P-IV-O

Story No.	Column size (mm x mm)	Beam size (mm x mm)	Shear wall thickness (mm)	Outrigger member
1-5	1100 x 1100	800 x 400	200	ISWB 450
6-10	1000 x 1000	800 x 400	200	ISWB 450
11-15	900 x 900	800 x 400	200	ISWB 450
16-20	800 x 800	800 x 400	200	ISWB 450

III. PERFORMANCE AND ANALYSIS

Maximum storey displacement: The graphs of lateral displacement are plotted in X and Y direction of model P-I-R, P-II-S, P-III-B, P-IV-O

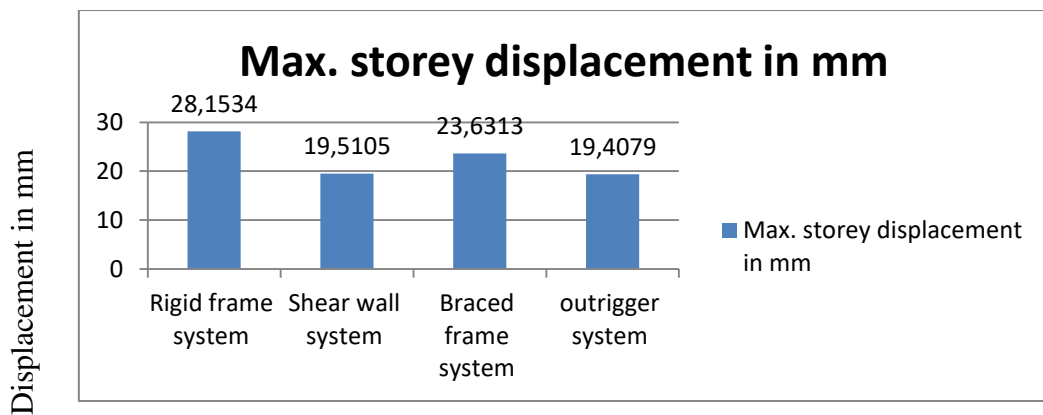

Max. Storey drift: The graphs of max. Storey drift between model P-I-R, P-II-S, P-III-B, P-IV-O

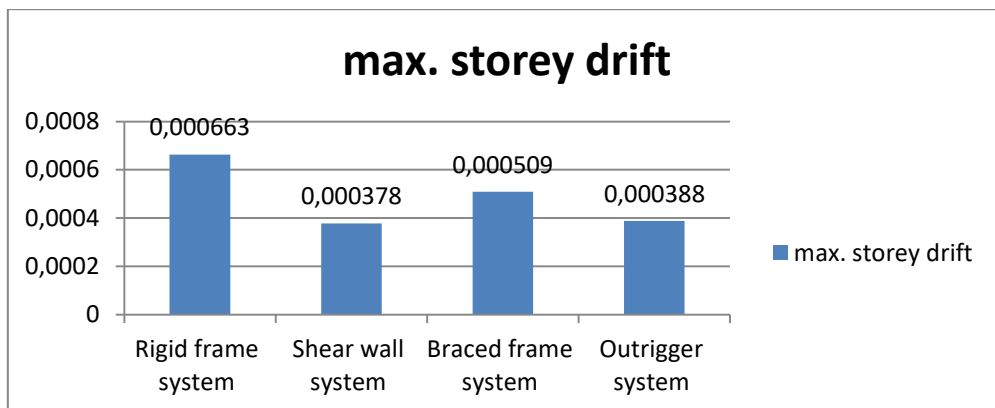

Storey shear: The graphs of storey shear of model P-I-R, P-II-S, P-III-B, P-IV-O

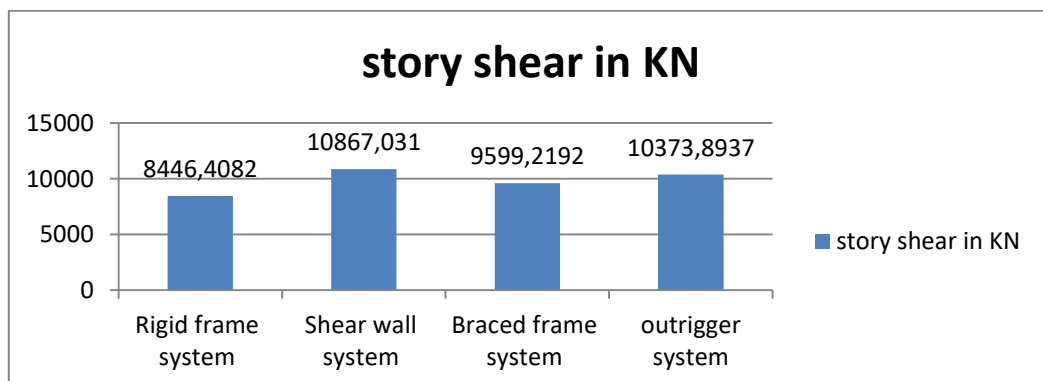

IV. CONCLUSION

After analyzing and comparing we have observed that:—

- Storey displacements are more reduces in case of outrigger system and shear wall system as compare to braced frame system and rigid frame system.
- Storey drift reduces at each floor in shear wall system and outrigger system. Finally, it is concluded that the result are highly effective in 20 Storey buildings in zone-5 respectively when shear wall & outriggers are used.
- From the Base shear point of view, it is analyzed that base shear reduction is more in rigid frame system as compare to Shear wall system , Braced frame system and outrigger system.
- Hence it is finally concluded from all the above results that, shear wall system and outrigger system in building structure is more resilient in the event of the earthquake.

REFERENCES

1. Smith Stafford Bryan, Coull Alex (1991), **High rise Building Structures-Analysis and Design**, Wiley-Interscience. IS 1893: 2002 for **Earthquake Resistant Design**.
2. IS 456: 2000, **Plain and Reinforced Concrete: Code of Practice**.
3. Oni P. B. and Vanakudre S. B. (2013), "**Performance based evaluation of shear walled RCC Building by Pushover analysis**. IJMER Vol.3 Issue4.
4. Vaisakh K.N., Nair N. (2021), **Seismic Evaluation of High Rise Buildings Using Hybrid Configuration of Grid Systems**, In: Dasgupta K., Sudheesh T.K., Praseeda K.I., Unni Kartha G., Kavitha P.E., Jawahar Saud S. (eds) Proceedings of SECON 2020. SECON 2020. Lecture Notes in Civil Engineering, vol 97. Springer, Cham. https://doi.org/10.1007/978-3-030-55115-5_16
5. Patil Dhanaraj M., Sangle Keshav K. (2016), "**Seismic Behaviour of Outrigger Braced Systems in High Rise 2-D Steel Buildings**", Structures, Vol 8, <https://doi.org/10.1016/j.istruc.2016.07.005>.
6. Vivinkumar.R.V. (2015), "**A Comparative Study on Force Based Design and Direct Displacement Design of Reinforced Concrete Frames**", International Journal of Research in Engineering and Technology, <http://dx.doi.org/10.15623/ijret.2015.0404009>.
7. Huang, Mingfeng (2017), **High-Rise Buildings under Multi-Hazard Environment**, Assessment and Design for Optimal Performance, Springer Publication, DOI: 10.1007/978-981-10-1744-5.
8. Ashish Kumar Chaudhary, Satyabrata Choudhury (2019) "**Performance of RC Frame Base-Isolated Building with Geotextile as Isolator Using UPBD Method**", Journal of The Institution of Engineers (India): Series A, Volume 101, Issue 1, doi:10.1007/s40030-019-00421-8.
9. Mehmed Causevic, Sasa Mitrovic (2010), "**Comparison between non-linear dynamic and static seismic analysis of structures according to European and US provisions**", Bulletin of Earthquake Engineering, **9**, 467–489 (2011). <https://doi.org/10.1007/s10518-010-9199-1>.
10. Wael Alhaddad, Yahia Halabi, Hu Xu, HongGang Lei (2020), "**Outrigger and Belt-Truss System Design for High-Rise Buildings: A Comprehensive Review Part II—Guideline for Optimum Topology and Size Design**", Advances in Civil Engineering, Volume 2020 |Article ID 2589735 | <https://doi.org/10.1155/2020/2589735>.



INNO SPACE
SJIF Scientific Journal Impact Factor
Impact Factor: 8.423



ISSN INTERNATIONAL
STANDARD
SERIAL
NUMBER
INDIA



INTERNATIONAL JOURNAL OF INNOVATIVE RESEARCH

IN SCIENCE | ENGINEERING | TECHNOLOGY

9940 572 462 6381 907 438 ijirset@gmail.com



www.ijirset.com

Scan to save the contact details